

- LEGEND -

-  EXISTING TREE
-  TREE TO BE REMOVED
-  CONCRETE
-  ASPHALT

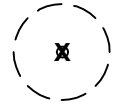
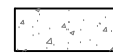
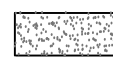
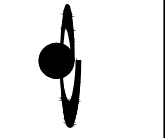
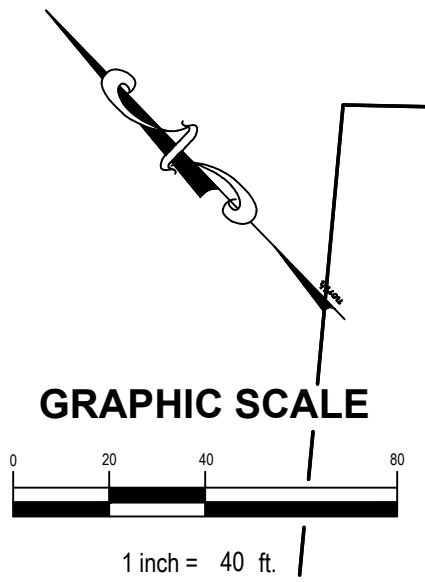
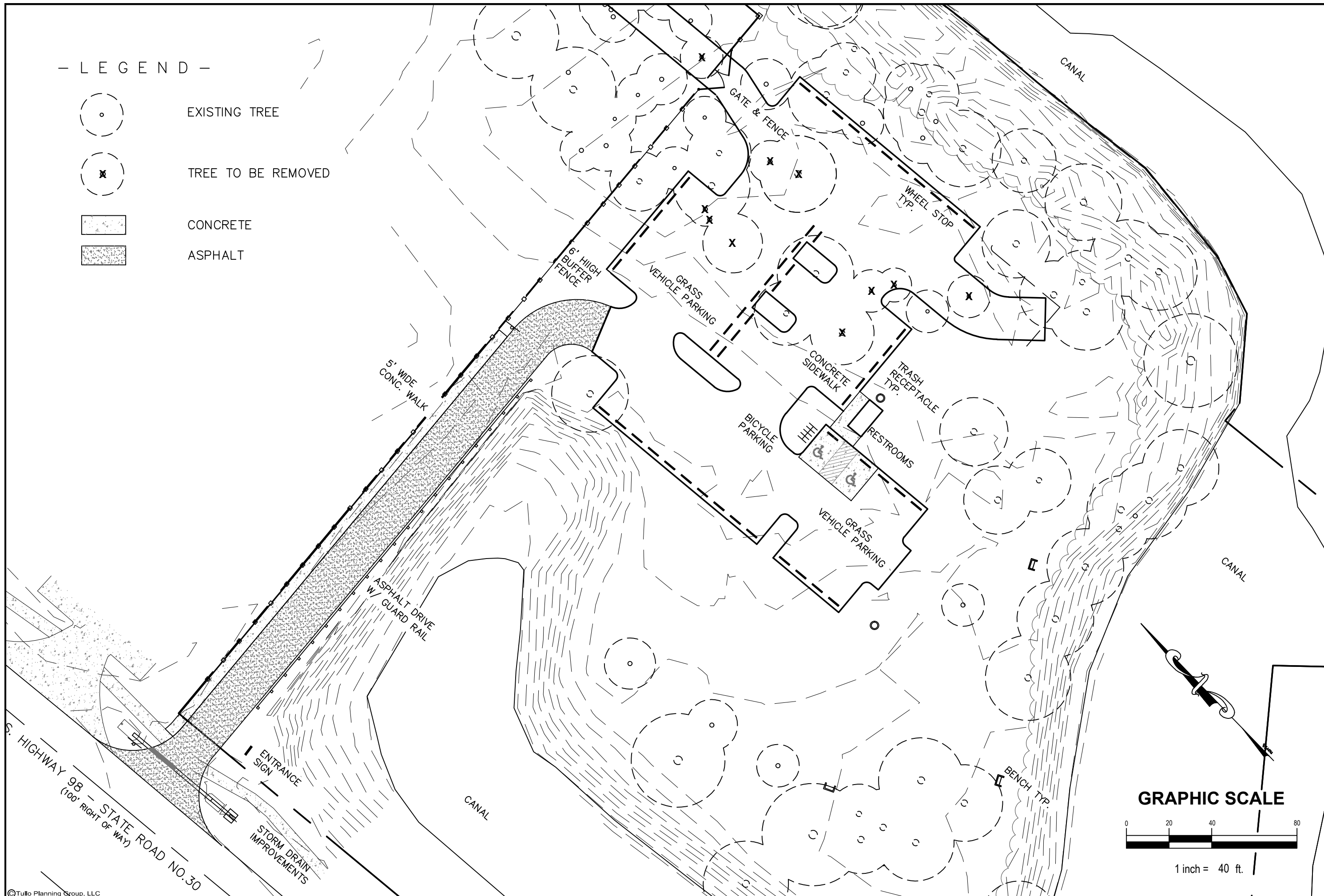

LAND USE PLANNING
LANDSCAPE ARCHITECTURE
p.o. box 27601
panama city beach, florida 32411
ph. 850.527.0632
fax. 850.235.3997
gpln@comcast.net
www.tulloplanning.com

PROJECT NAME	PARKER PARK
CLIENT NAME	CITY OF MEXICO BEACH

REVISIONS	
-----------	--

DATE	12-30-15
CONTRACT #	58-003
DRAWN BY	GMTW

The drawings, specifications and other documents prepared by TULLO PLANNING GROUP, LLC for this project are the property of TULLO PLANNING GROUP, LLC and are to be used only for the project and site identified herein. No part of these drawings, specifications or other documents may be reproduced, stored in a retrieval system, or transmitted in any form or by any means, electronic, mechanical, photocopying, recording, or by any information storage and retrieval system, without the prior written permission of TULLO PLANNING GROUP, LLC.

SHEET TITLE	PHASE I MAP
-------------	----------------

GINA TULLO-WILLIAMS
FL. REG. NO. LA0001546

SEAL	2.0 SHEET
------	---------------------